

Sync I

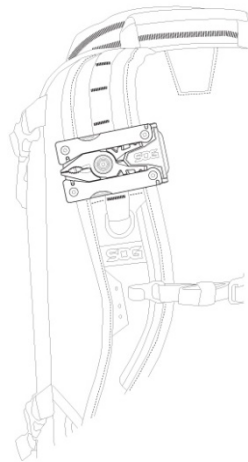

PRODUCT TYPE	MULTI-TOOL
BLADE SHAPE	CLIP POINT
BLADE STEEL	5CR15MOV
BLADE EDGE	STRAIGHT
BLADE LENGTH	1.5"
HANDLE	STAINLESS STEEL
FINISH	BEAD BLAST
OVERALL LENGTH	4.4"
CLOSED LENGTH	2.4"
PRODUCT WEIGHT	2.6 OZ
COMPONENTS	11
PRODUCT NUMBER	SN1001-CP
UPC	729857006408



Whether it's used as a belt buckle or clipped on a pack, the Sync multi-tool is there to save the day anytime and anywhere.

The functionality of a multi-tool is useless if you don't have it on hand when you need it. The Syncs are multi-tools designed to easily be worn with the detachable base as a belt buckle or simply clipped on a pack strap or boot. That way, anywhere you go, your multi-tool is there with you. While the tool can be conveniently detached from the base with one hand, it stays locked and secure to it under active movement when not needed. Sync I fits belts up to 1-3/8". Thicker belts up to 1-3/4" are compatible with the Sync II. They come equipped with a selection of frequently used components that are available at a moment's notice to save the day anytime and anywhere.

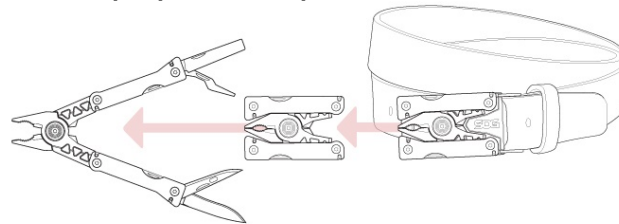

COMPONENTS

Pliers
Gripper
Crimpers
Awl
3-Sided File
Soft Wire Cutter
Straight Blade
Small Flat Screwdriver
Jewelry Driver
Bottle Opener
Ruler

- Wearable multi-tool with a detachable base designed to be worn as a belt buckle or clipped on a pack or boot.
- Includes a selection of frequently used components that are available at a moment's notice.
- Sync I fits belts up to 1-3/8" wide.
- Total Components: 11
- Open Length: 4.4-inches; Closed Length: 2.4-inches; Weight: 2.6 oz.; Lifetime Warranty.